

BALDWIN®

Baldwin
Technical Support
1-800-566-1986
www.baldwinhardware.com

Additional Information about
Baldwin's adjustable latch here:



Required tools



INSTALLATION INSTRUCTIONS FOR NO. 5540 SERIES LATCH WITH 1-1/2" AND 2-1/8" CYLINDRICAL CUTOUT

Note: 5540 Series latch can work on non-bored door condition for knobs only.

- A** Hold the latch in front of the door hole, with the latch face flush against the door edge.

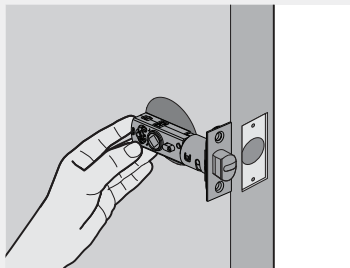

- B** Is the diamond shaped hole centered in the door hole?

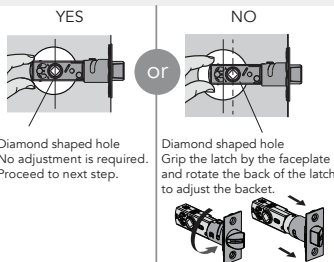

- C** Make sure the bevel side of the plain latch is facing the door jamb.

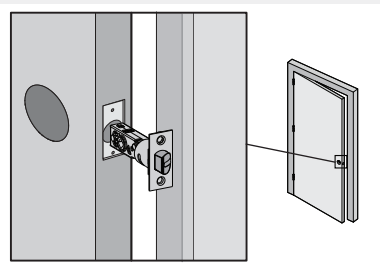

- D** While holding the latch to the door with the bevel side of the bolt facing the door frame, **adjust the toggle to the upper L position for levers or the middle K position for knobs.**

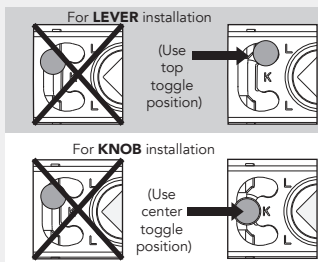

- E** FOR PRIVACY FUNCTION ONLY: Remove the spacer and the #1 Phillips head screw on the side of the latch that will be facing the interior. The spacer is either round or oval in shape. DO NOT remove exterior screw and spacer.

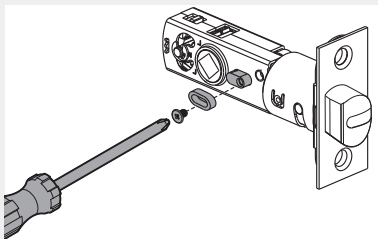

- F** Insert latch into the door and secure using (2) #8 x 3/4 in (19 mm) screws.

