

BALDWIN

Cremone Bolt

Installation Instructions

Baldwin Cremone Bolts are manufactured in two sizes. The 7' standard size is furnished with a 38.875" bottom rod, a 40.875" top rod and four (4) guides. It is intended for installation on doors 7' high or less.

The 8' size is furnished with a 38" bottom rod and a 52" top rod and is for installation on doors of 8' or less. Doors over 8' high will require the use of a Cremone Bolt Extension Rod Kit, which will allow installation on Cremone bolts on doors up to 12' high.

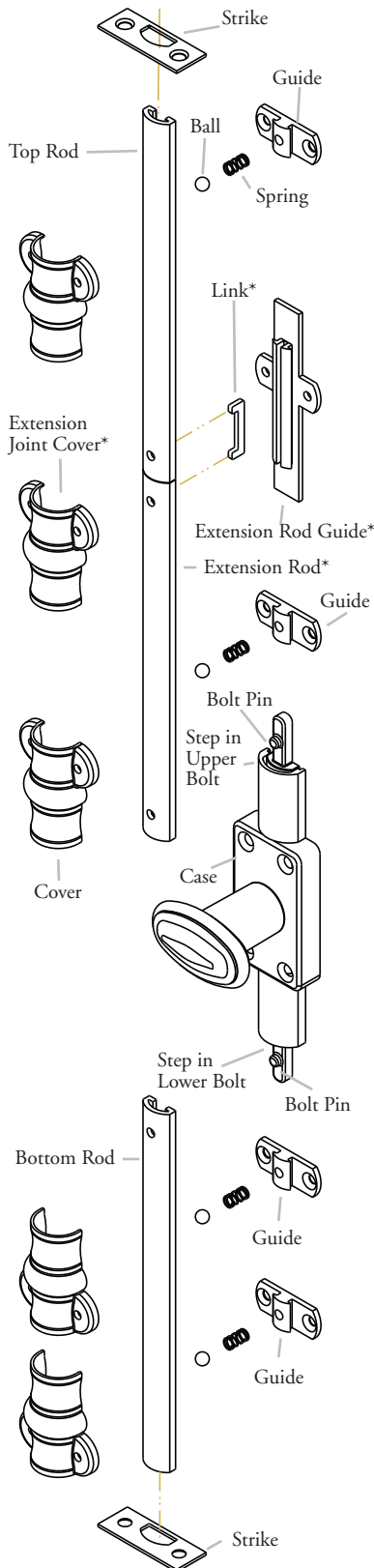

NOTE: Parts marked with an asterisk (*) are included with the extension rod assembly only—not required on doors under 8'0" high.

1. Mark the knob center line height (42" from the bottom of the door is recommended). Establish a vertical centerline to locate the center of the guides. Good vertical alignment of the case and guides is critical to smooth operation.
2. Mark the positions of the case screws and guide screws, taking care that the guides are perpendicular to the vertical centerline. If you are using an extension kit, do not position the extension guide at this time.
3. Drill a 3/4" hole 3/8" deep for spindle clearance behind the case (if trim is to be installed on the outside of the door, drill this hole through), pilot holes for the case screws, and pilot holes for the guide screws.
4. Assemble the spindle and knob (lever) on the lock as follows (see Fig. 1). Slide washer onto knob (lever). Slide/thread spindle fully onto knob (lever), fasten with set screw(s). Slide spindle through lock and fasten with machine screw.
5. Check to see that our mechanism is the proper hand. This information is stamped on the backplate, but handing may also be checked as follows:

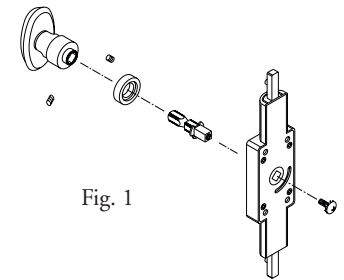

Fig. 1

A left handed lock retracts when it is turned clockwise - a right handed lock retracts when it is turned counterclockwise.

6. Fasten the case to the door using the wood screws supplied. Levers should extend in the direction of the door hinges, knobs should have the set screws on the bottom.
7. If you are using an extension kit, assemble the top rod and extension at this time. See the step by step instructions for installing a "Cremone Bolt Extension Rod Assembly".
8. With the lock in the retracted position, measure from the floor surface to the step in the lower bolt. Saw the shorter of the two rods 1/16" shorter than this measurement. (Do not cut off the end with the hole in it). Now measure from the door frame to the step in the upper bolt. Cut the longer rod 1/16" shorter than this measurement. (Again, do not cut off the end with the hole). **If you are using an extension kit assemble the top rod and extension before trimming, do not trim the extension rod.** File the cut ends for smooth function and good appearance.
9. Install top and bottom rods as follows:
 - a. Preload the guides with spring and ball. Slide the guides into the slot in the rod.
 - b. Place the hole in the rod end over the pin on the end of the bolt.
 - c. If you are using plain guides without covers, screw the guides down at predrilled positions. If you are using covers, the guides are not screwed directly to the door, but are held in place by the covers, which are placed over the guides and fastened to the door.

(If you are using an extension kit, make sure that the lock is still in retracted position, then place the cover over the extension guide and position it so that the cover just conceals the link. Mark this position, remove the cover, and drill pilot holes. Replace the cover and fasten it to the door.)

 - d. Close the door and partially extend the rods so the locations of the strikes can be determined. Mark the positions of the strikes and remove enough material to allow the strike to lie flush with the surface. The bolt should extend into the surface 3/4".
 - e. Fasten the strikes in position and test the bolt for proper functioning.



Cremone Bolt Extension Rod Assembly Instructions

The Cremone Bolt Extension Rod Assembly consists of one rod with a hole at each end, a guide and link to join the extension rod and the top rod, and a cover to conceal the joint.

Assembly of the joint is simple but must be done in a specific sequence. If you are installing an extension rod for the first time, please follow the step-by-step instructions.

The guide assembly should be mounted so that the hole in the extension rod is concealed by the cover when the bolt is retracted.

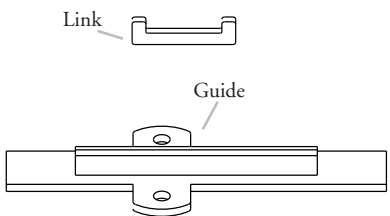
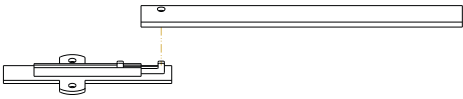
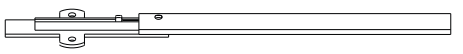
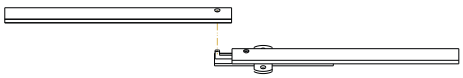
Proper alignment of the guides is critical to smooth operation; misalignment may cause stiffness or binding.

	<p>1. The extension rod guide assembly consists of two parts, the LINK and the GUIDE. When the joint is assembled, the ears on the link engage the holes in the ends of the extension rod and top rod, of the cremone bolt, holding them together. The link rides in the slot on the guide.</p>
	<p>2. Place the link in the slot on the guide, with one end half-way out of the slot.</p>
	<p>3. Place the extension rod on the link so that the ear on the link engages the hole in the rod end. If the 8106 Traditional Cover is to be used, be certain that the long end of the guide is positioned to face upward, toward the top rod.</p>
	<p>4. Slide the rod onto the guide rib and push it all the way to the end of the rib.</p>
	<p>5. Place the top rod so that the hole in the rod engages the link.</p>
	<p>6. Slide top rod onto the guide rib and push the assembled link to the center of the guide. The assembled extension and top rod are installed in the same manner as a solid top rod (See Step 8 on “Cremone Bolt Installation Instructions”), with the following caution: The guide assembly should be mounted so that the hole in the extension rod is concealed by the cover when the bolt is in the retracted (unlocked) position.</p> <p>Proper alignment of the guides is essential to smooth operation.</p>

Warranty Information

Limited Lifetime Mechanical Warranty – Baldwin warrants that each Baldwin product shall be free from mechanical defects at the time of delivery and for the lifetime of the product or as long as you own your home.

Limited Lifetime Finish™ Warranty – The Baldwin Lifetime Finish™ uses advanced finishing technology (physical vapor deposition) to create a finish highly resistant to the effects of weather and normal wear and tear. The Limited Lifetime Finish Warranty on Lifetime Finish™ products covers the original purchaser for as long as you own your home.

Limited Finish Warranty – The finish on Baldwin products (excluding Lifetime Finish and living finish products) is protected by a durable topcoat designed to maintain the beauty and quality of the Baldwin product. The Baldwin Limited Finish Warranty covers the original purchaser for five years from date of purchase for interior use and one year for exterior use.

Living Finishes – Due to the nature of Baldwin living finish products, they will wear over time and may already have begun the process before reaching your home. No finish warranty is offered on living finish products, which are designed to age and improve over time. Living finishes include raw brass, oil rubbed bronze, stainless steel, and other non-lacquered or non-PVD finishes.

Refer to www.baldwinhardware.com for a complete warranty statement.