

BALDWIN®

MULTI-POINT

INSTALLATION INSTRUCTIONS

Entrance American

Cylinder Function

Exploded View

SPRINGFIELD TRIM SHOWN
SEE HARDWARE
CATALOG FOR HOLE SPACING

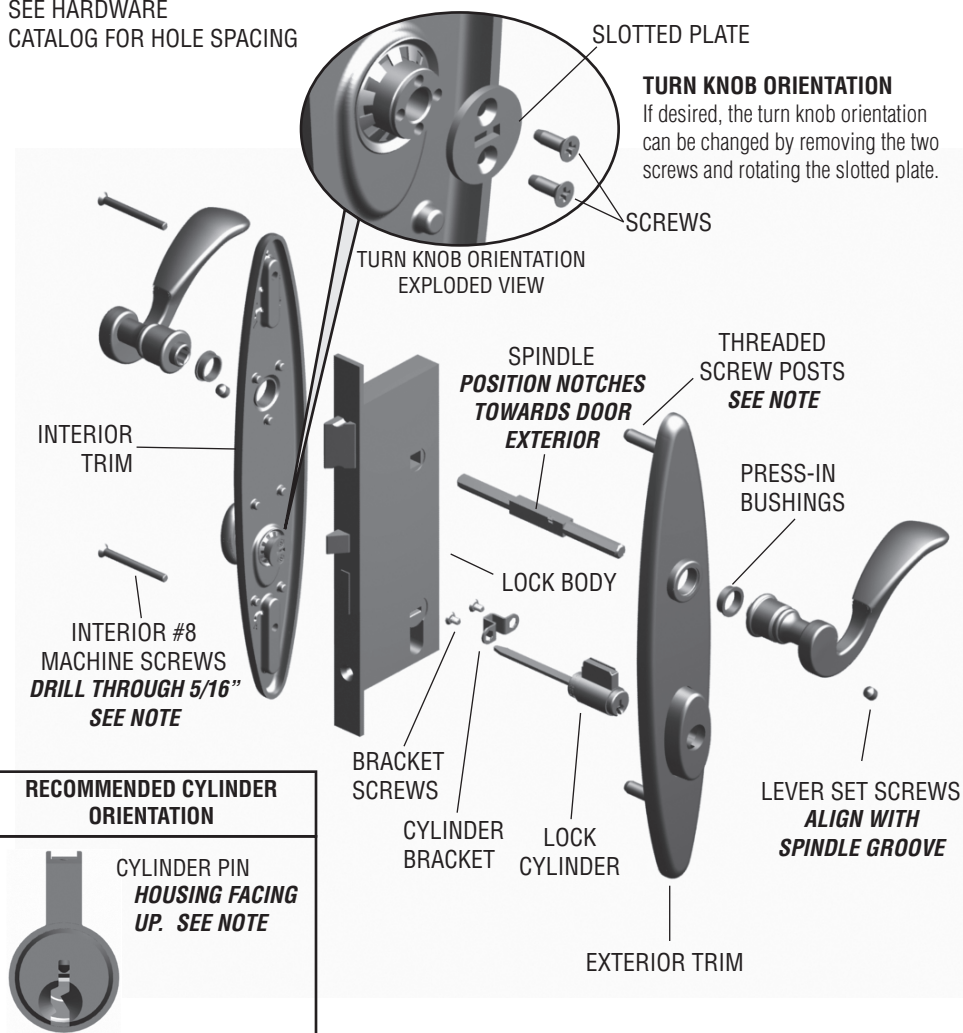

Lock Cylinder Note: Shown is the lever on the top of the lock cylinder. The lever may be on the bottom, depending on the lock.

#8 Machine Screws Note: Proper trim alignment requires installing the spindle and levers before completely securing the #8 screws.

Threaded Screw Posts Note: Length may need to be cut down to accommodate different door manufacturers' hole pattern.

BALDWIN®

MULTI-POINT

INSTALLATION INSTRUCTIONS

Patio American

Cylinder Function

Exploded View

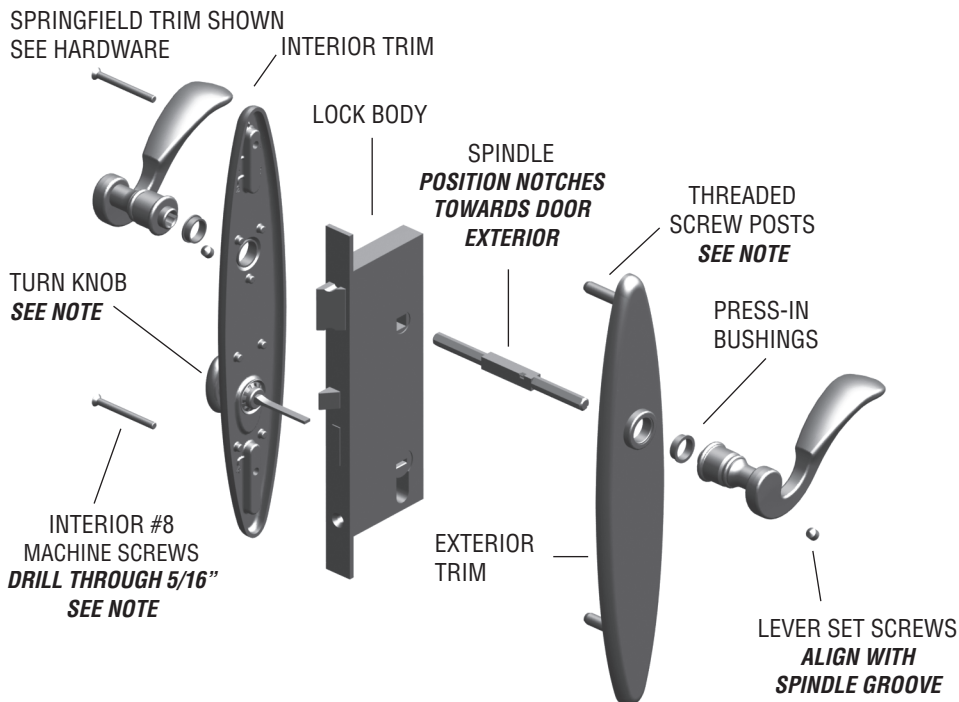

Turn Knob Note: Shown is the lever on the top of the turn knob. The lever may be on the bottom, depending on the lock.

#8 Machine Screws Note: Proper trim alignment requires installing the spindle and levers before completely securing the #8 screws.

Threaded Screw Posts Note: Length may need to be cut down to accommodate different door manufacturers' hole pattern.

Warranty Information

Limited Lifetime Mechanical Warranty – Baldwin warrants that each Baldwin product shall be free from mechanical defects at the time of delivery and for the lifetime of the product or as long as you own your home.

Limited Lifetime Finish™ Warranty – The Baldwin Lifetime Finish™ uses advanced finishing technology (physical vapor deposition) to create a finish highly resistant to the effects of weather and normal wear and tear. The Limited Lifetime Finish Warranty on Lifetime Finish™ products covers the original purchaser for as long as you own your home.

Limited Finish Warranty – The finish on Baldwin products (excluding Lifetime Finish and living finish products) is protected by a durable topcoat designed to maintain the beauty and quality of the Baldwin product. The Baldwin Limited Finish Warranty covers the original purchaser for five years from date of purchase for interior use and one year for exterior use.

Living Finishes – Due to the nature of Baldwin living finish products, they will wear over time and may already have begun the process before reaching your home. No finish warranty is offered on living finish products, which are designed to age and improve over time. Living finishes include raw brass, oil rubbed bronze, stainless steel, and other non-lacquered or non-PVD finishes.

Refer to www.baldwinhardware.com for a complete warranty statement.